

Location

From Sutton mainline train station, turn right into High Street, turn left into the A232, proceed along the one way system and turn right into St James' Road. Proceed along St James' Road until the corner of Sydney Road, the property is located on the right hand side.

Location Map



EPC Graph

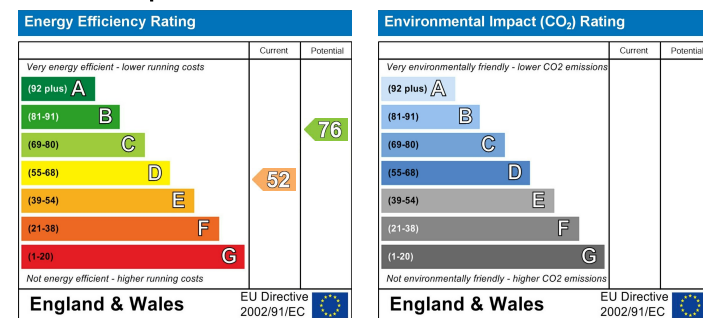

Important Note

Centro Residential Sales and Lettings limited have not tested any services, heating system, electrical system, appliances, fixtures and fittings, that may be included in this property and would advise interested parties to satisfy themselves as to their condition or investigating the presence of any deleterious materials.

Viewing: Strictly by appointment through:

CENTRO RESIDENTIAL SALES AND LETTINGS LIMITED

Tel: 020 8401 5000

E-mail: residential@centro.plc.uk

See a selection of our properties at www.centro.plc.uk

£1,300 Per Month - 2nd September 2024
St. James' Road, Sutton, Surrey SM1 2TY



Description

- AVAILABLE NOW
- ONE BEDROOM
- GARAGE
- FURNISHED
- EPC RATING E
- COUNCIL TAX BAND B

Features

- Double glazing
- Garage

What you need to know

- Term: 12 months
- Rent: £1150pcm exclusive of bills
- Security deposit: £1326.00
- Council tax: B -
- Energy rating: E



Floor Plan

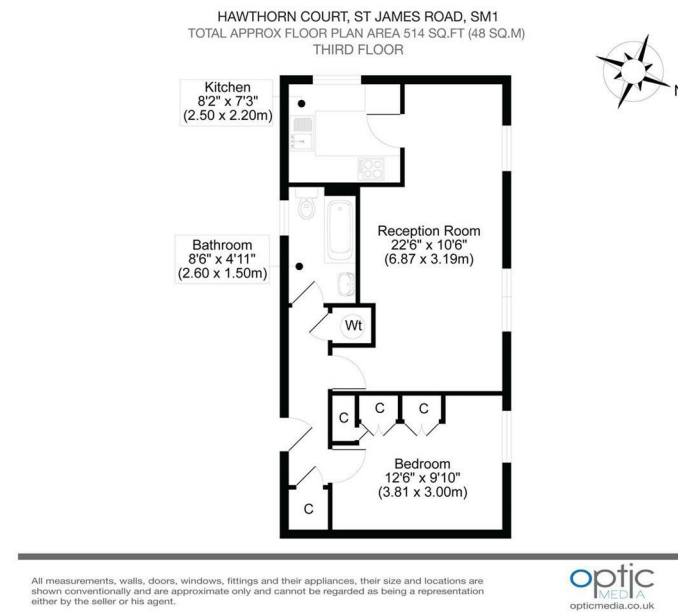

For illustration purposes only



All dimensions and measurements are approximate and for guidance only.

Just Centro's Opinion...

A well presented top floor one bedroom apartment located within walking distance to both Sutton and West Sutton stations, as well as Sutton High Street. The property benefits from entrance hallway with storage cupboards, spacious lounge, separate fitted kitchen, one double bedroom and a bathroom.

Additional benefits include en-bloc Garage, double glazed windows throughout, electric heating and secure entry phone system.

Offered furnished and available now!

Additional Photos

